

# 17-0 Separating device with quick-action clamping spindle



## APPLICATION IMAGE



## DESCRIPTION

The Series 17 separators are used together with the Series 18 pullers for removing ball bearings, roller bearings, inner rings and other flat parts in trade, industry and workshops when there is not enough space for pulling hooks. The separating and extracting process is able to gently separate these parts before they can be extracted from the outside. Compared to the 15 series, the 17 series is particularly easy to handle because the separating jaws are clamped quickly and centrally by a pressure spindle.

## RANGE OF APPLICATION

Together with the extractors of series 18 for extracting ball bearings, roller bearings, inner rings and other parts lying flat

## BENEFIT

- Simple and safe handling is made possible by the quick-release pressure spindle
- The sharp cutting edges enable stripping where other stripping methods cannot be used
- The screw connection between the separating and extracting device ensures maximum stability during extraction
- If the separating jaws are screwed into the tightening device the other way round, the contact surface is enlarged and pulled off more gently

## OPERATION

- Press the sharp cutting edges of the cutting device behind the part
- Tension the separator jaws by actuating the pressure spindle and ensure that the separator blades are positioned under the part to be removed as far as they will go
- Screw the pull bolt of the puller into the threaded holes of the separator as far as it will go
- Hold the separating device firmly and pull off the relevant part safely and carefully by tightening the clamping nut

## MASTER DATA

GTIN [EAN]	4021176008108
Country of origin	DE
Case material	Tool steel
Series	17
Net weight [kg]	0,95 kg
Package contents	1 piece
Packaging Act	PAP 21

## SPARE PARTS

- 17-0-06\_Pressure spindle
- 17-0-T\_Traverse
- 017140\_Side bolt with nut

# Separating device with quick-action clamping spindle

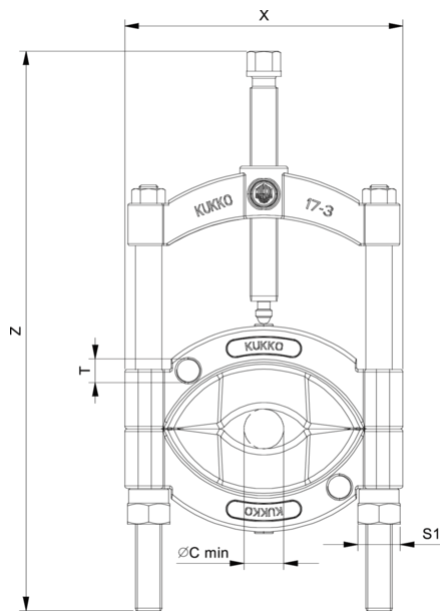

Abbreviation	Attribut	Wert
X	Total width [mm]	100 mm
Y	Total depth [mm]	19,5 mm
Z	Total height [mm]	205 mm
S1	Width across flats [mm]	17 mm
Cmin	Cut-off diameter (min.) [mm]	8 mm
Cmax	Separating diameter (max.) [mm]	60 mm
K	Cutting edge thickness at the tip [mm]	0,3 mm
O	Usable snow depth [mm]	21 mm
H	Total cutting edge height [mm]	39,5 mm
L	Rear cutting edge thickness [mm]	5,5 mm
T1	Mounting thread for tension bolt [nominal dimension] M10	

Abbreviation	Attribut	Wert
X	Total width [mm]	100 mm
Y	Total depth [mm]	19,5 mm
Z	Total height [mm]	205 mm
S1	Width across flats [mm]	17 mm
Cmin	Cut-off diameter (min.) [mm]	8 mm
Cmax	Separating diameter (max.) [mm]	60 mm
K	Cutting edge thickness at the tip [mm]	0,3 mm
O	Usable snow depth [mm]	21 mm
H	Total cutting edge height [mm]	39,5 mm
L	Rear cutting edge thickness [mm]	5,5 mm
T1	Mounting thread for tension bolt [nominal dimension] M10	

A-A

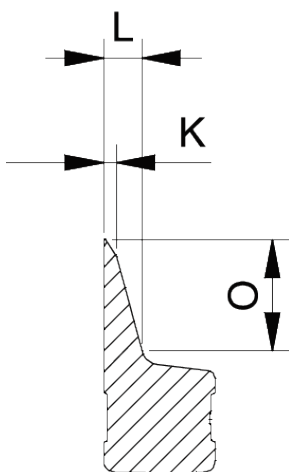

Abbreviation	Attribut	Wert
X	Total width [mm]	100 mm
Y	Total depth [mm]	19,5 mm
Z	Total height [mm]	205 mm
S1	Width across flats [mm]	17 mm
Cmin	Cut-off diameter (min.) [mm]	8 mm
Cmax	Separating diameter (max.) [mm]	60 mm
K	Cutting edge thickness at the tip [mm]	0,3 mm
O	Usable snow depth [mm]	21 mm
H	Total cutting edge height [mm]	39,5 mm
L	Rear cutting edge thickness [mm]	5,5 mm
T1	Mounting thread for tension bolt [nominal dimension]	M10